



52108NW0002 2.4698 CRESCENT LAKE

010

2.4698

**BIRD RIVER MINES CO. LTD.**

**RECEIVED**

22-2~~AB~~ - 2 1982

Strategic Metals

MINING LANDS SECTION

Zig Zag Lake Prospect - Ontario

Based on 36 channel samples cut over widths totalling about 155 feet weighing 215 lbs. and 28 host-rock geo-chemical, samples taken over widths totaling 510 feet, we have found the following values of strategic minerals in the rock:

Tantalum	1/2 pound to 7 pounds/ton
Gallium	approx. 1/2 pound per ton
Beryllium	recoverable amounts
Lithium	over 2500 tons per vertical foot and grade of over 1.60% lithia, sampling along the centre of the pegmatite dykes.

Specific details of sampling procedures, locations of channel are in the reports and Plan No. 2. Sample material and some pulps are on hand for further examination.

The increased importance of these minerals has been well documented in the literature, for example:

- (1) Tantalum - The Northern Miner, February 11, 1982,
- (2) Gallium - Canadian Research, October, 1981,
- (3) Beryllium - Fortune Magazine, June 15, 1981,
- (4) Dollar, The International Journal of American Investments, 1982, and
- (5) Lithium - Mining Magazine (London, England) January, 1982.

This increased interest in strategic metals is based in part on the use of these materials in the high technology expansion in nuclear power and specialized electronics.

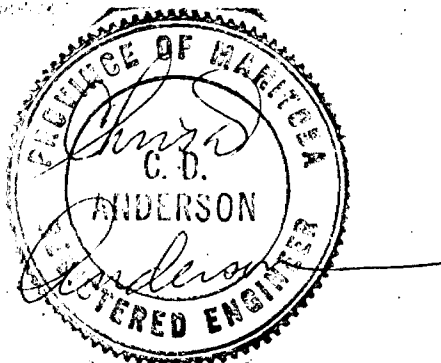

Chris D. Anderson, Ph.D., P.Eng.  
Consultant

November 26, 1971

Manitoba Securities Commission  
379 Broadway Avenue  
Winnipeg 1, Manitoba

Dear Sirs:

Re: Prospectus - Bird River Mines Co., Ltd.  
Dated November 25th, 1971

I, Christian Donald Anderson, of 826 Dorchester Street, Winnipeg, Manitoba, professional engineer, hereby certify:

1. That I graduated as a geophysicist from the University of Utah, U.S.A. in 1966 and subsequently spent one and one-half years in the field in mining geophysics.
2. That I am currently employed as a professor of geophysics at the University of Manitoba, Geological Department.
3. That I have been a consulting professional engineer for the past four years.
4. That I have read the prospectus in its entirety and all references made therein on pages 2, 4, and 5 in particular with respect to my reports on Savant - Sturgeon Lake group and Austin Amazon group are correct and not misleading and are in no way contradictory to the reports.
5. That I am the recorded and beneficial owner of 250 shares of the capital stock of Bird River Mines Co., Ltd. which I held for some time and that I neither will nor expect to receive any additional interest in the said company.

Yours very truly,

  
Chris D. Anderson, Ph.D., P.Eng.

BIRD RIVER MINES

J. DONNER

Sample Number	Elements In									
	%Ba		lb/Ton							
79-10	.0334		.66							
-11	.0272		.54							
-12	.0100		.20							
-13	.0142		.28							
-14	.0100		.20							
-15	.0300		.60							
-16	.0214		.43							
-17	.0043		.09							
-18	.0130		.26							
-20	.0137		.27							
-21	.0097		.19							
-24	.0080		.16							
-25	.0210		.42							
-26	.0098		.20							
-27	.0058		.12							
-28	.0175		.35							
-30	.0200		.40							
-31	.0200		.40							
-35	.0060		.12							
-41	.0442		.88							

Department of Earth  
University of Manitoba

*Handwritten:*  
J. Donner  
February 19, 1982



# BONDAR-CLEGG & COMPANY LTD.

764 BELFAST ROAD, OTTAWA, ONTARIO, K1G 0Z5

PHONE: 237-3110

## Certificate of Analysis

TO Bird River Mines Co. Ltd.  
98 Balmoral Street  
Winnipeg, Manitoba R3C 1X4

REPORT NO. A-12-58  
DATE January 27, 1982

I hereby certify that the following are the results of analyses made by us upon the herein described .... pulp ..... samples

MARKED	ppm								
	Be								
79-11	95								
79-17	28								
79-21	39								
79-41	200								
80-3	58								

BONDAR-CLEGG & COMPANY LTD.

NOTE:  
Rejects retained two weeks  
Pulps retained three months  
unless otherwise arranged.

*Ala. Kaulke*  
.....

ALONG GRANITE CONTACT 500' WIDE

Nos	Ft	Lbs	Ta	Be
79-9	76	7.2	.019	
79-18	2	5	.020	.013

Note: Sections of Tantalite crystals up to 2 inches  
NOT SAMPLED

Greenstone	No	Ft	Lbs	Ta	Be
	79-30	4'8"	10.5	.020	.020

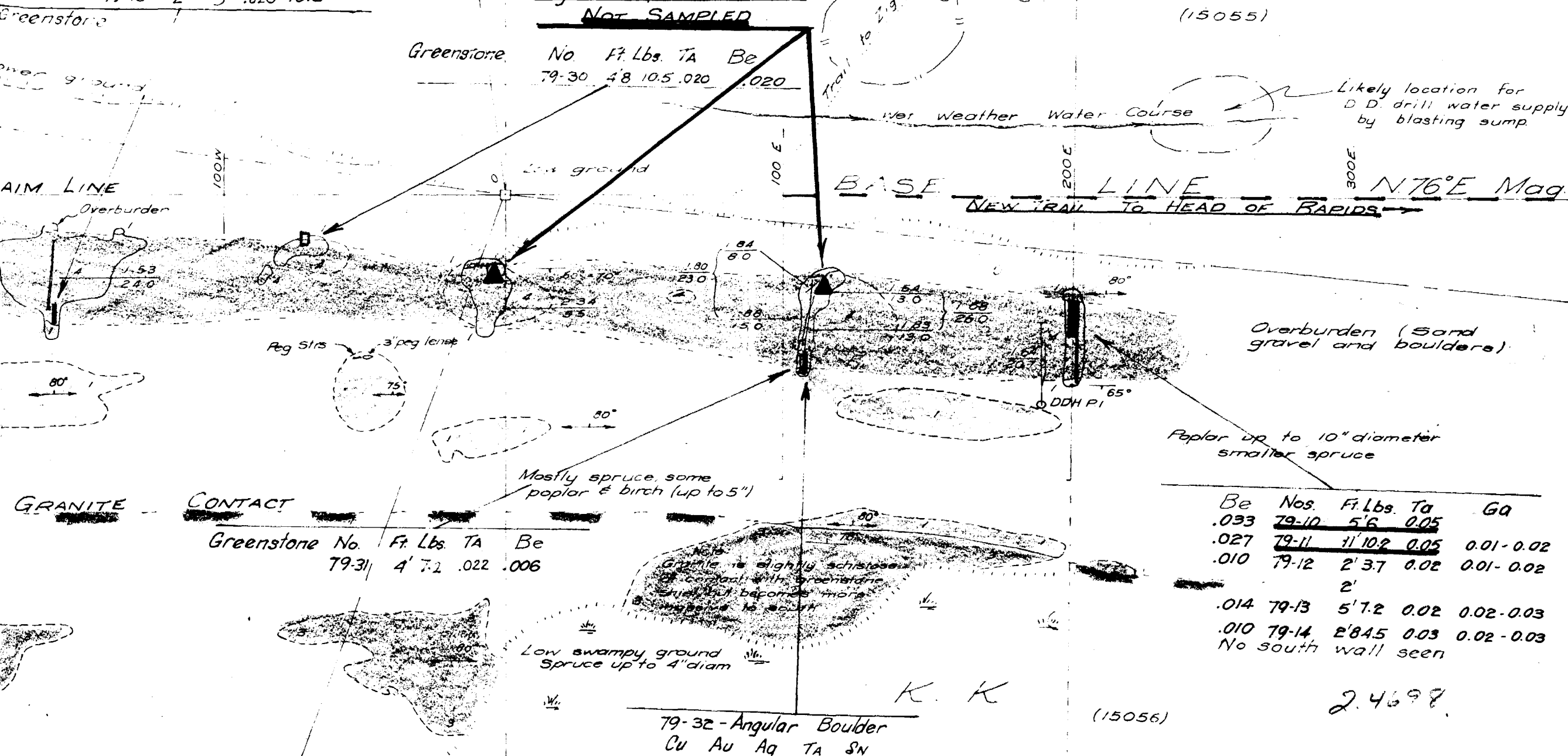

Greenstone	No	Ft	Lbs	Ta	Be
	79-31	4'	7.2	.022	.006

Be	Nos	Ft	Lbs	Ta	Ga
.033	79-10	5'6"	0.05		
.027	79-11	11'10.2	0.05		0.01-0.02
.010	79-12	2'3.7	0.02		0.01-0.02
		2'			
.014	79-13	5'7.2	0.02		0.02-0.03
.010	79-14	2'8.45	0.03		0.02-0.03

No south wall seen

79-32 - Angular Boulder  
Cu Au Ag Ta Sn

2.4698

redrawn from work done by  
ster Explorations Ltd., on former  
al Claims - K.K.15055, K.K.15056,  
159 and K.K.15060

Signed: (R.G. Hoiles, Ph.D.)  
Consulting Geologist  
June 9th 1958.

- 1 Lithium bearing pegmatite
- 2 Albite-microcline granite
- 3 Basic intrusive (diabase?)
- 4 Schistose basic volcanics

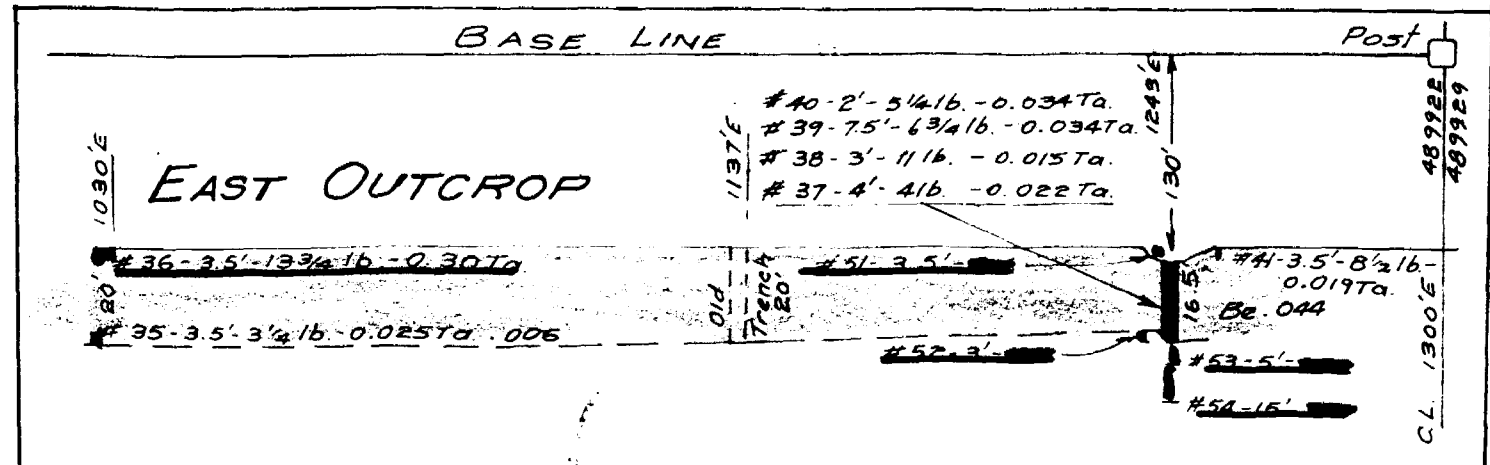

No. F. Lbs TA Be  
79-28 1 7 .028 .017

No. F. Lbs TA  
79-29 3 6 5.2 081

Greenstone  
LITHIUM POTENTIAL GROUND  
(15060)

burden

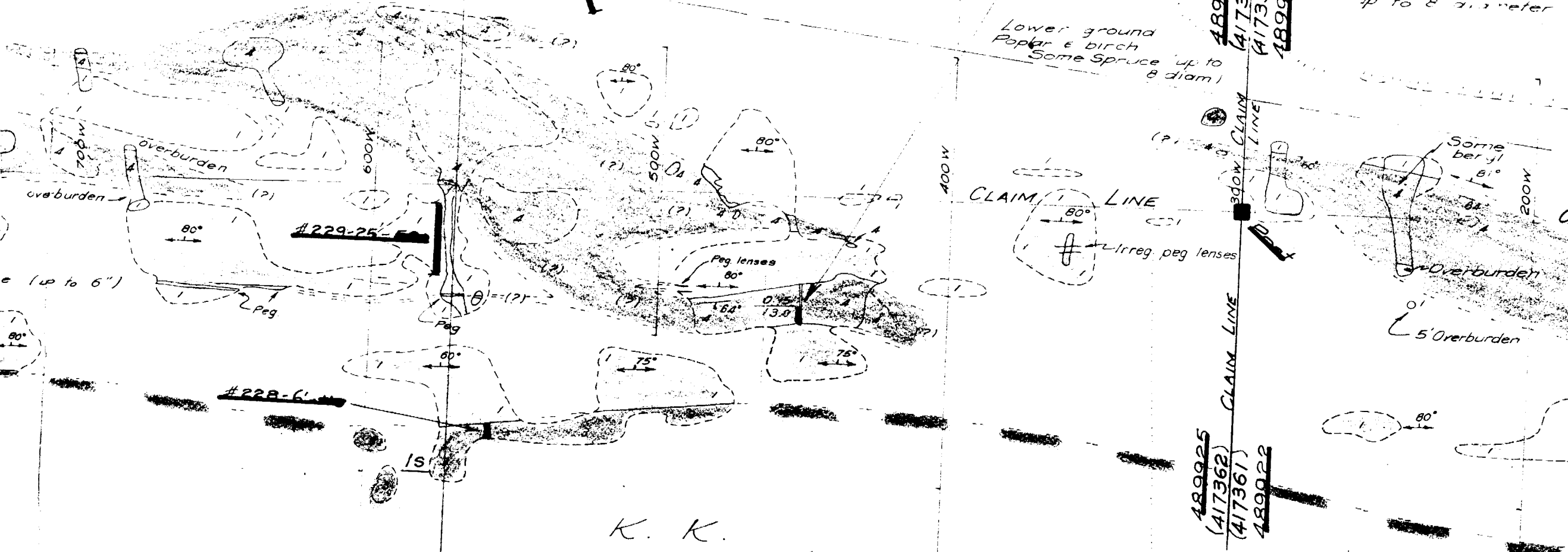
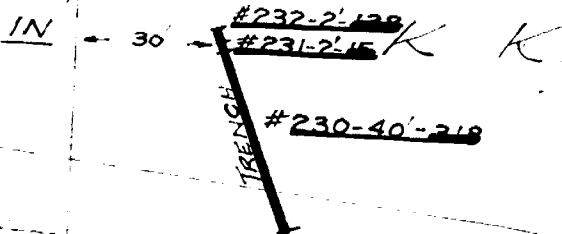

K. K.  
(15059)

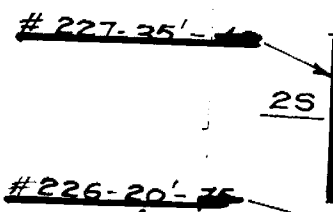

PLAN No. 2  
MAIN SHOWING  
IN  
**LITTLE JACKFISH RIVER AREA**  
Kowkash Mining Division - Ontario.

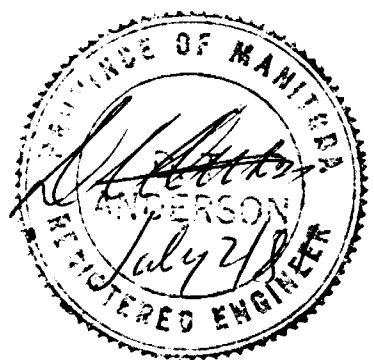
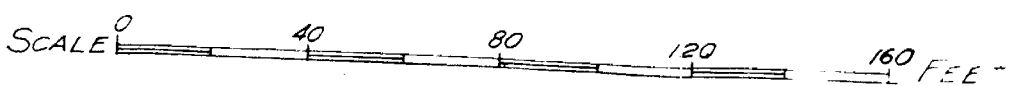

Note:  
Plan  
Demp  
Miner  
KK150

IES  
PLAN NO. M-2609

1-189922-189925-1979

1-1981

Note: Host-rock sampling results showing Lithium values in PPMillion and the width of samples are plotted Background readings for the vicinity appear to be below 20 PPM shown on Magnetic Survey Plan No.3

Greenstone	Nos.	Ft. Lbs	TA	Be
	79-20	2'	7.7	.024 .013
	79-21	16.6	7.7	.020 .009
	79-22	1	12	.005
	79-23	1	1.2	.001
	79-24	8'	7.2	.032 .008
	79-25	13'	9	.023 .021
	79-26	2'	7	.016 .009
	79-27	2'	3.2	.015 .005

49' feet.

Mag North.

Nos.	Ft. Lbs	TA	Ga	Be
79-15	28	5.5	0.05	0.02-0.03 .030
79-16	22	3	0.02	0.01-0.02 .021
79-17	36	5.1	0.35	0.01-0.02 .004

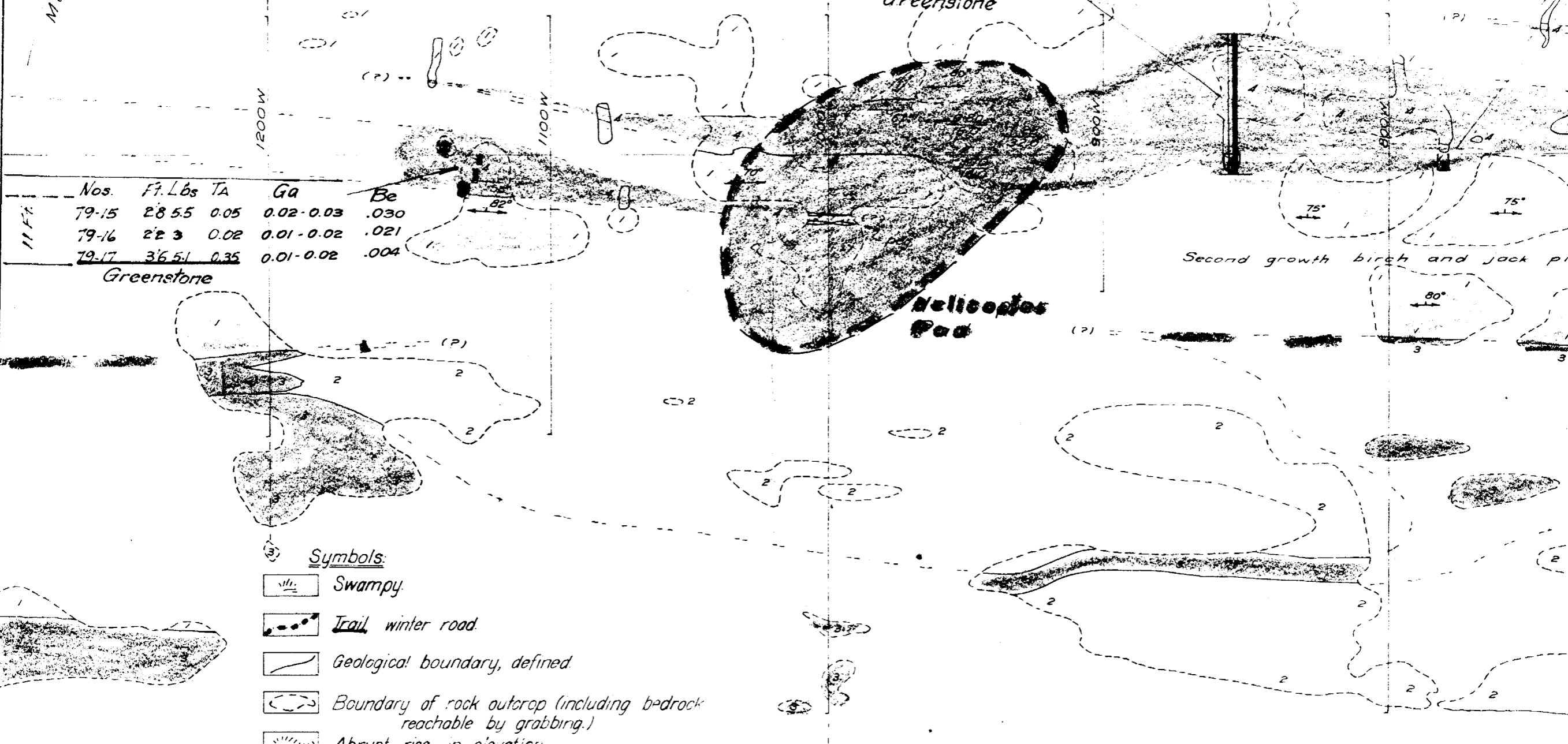

- Symbols:**
- Swampy.
  - Trail winter road.
  - Geological boundary, defined.
  - Boundary of rock outcrop (including bedrock reachable by grabbing.)
  - Abrupt rise in elevation.
  - Strike and dip of schistosity.
  - Claim corner.
  - Geological boundary, approximate.
  - Strike and dip of contact.
  - Claim line, approximate.

- Diamond drill hole.
- Picket line.
- Channel sample = 1979.
- Trenching and stripping.

**BIRD RIVER MIN**  
**CRESCENT LAKE SECTION**  
Claim Nos. (417358 - 417369)



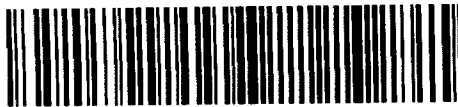

1982 12 06

2.4698

Mrs. Audrey Hayes  
Mining Recorder  
Ministry of Natural Resources  
P.O. Box 5000  
Thunder Bay, Ontario  
P7C 5G6

Dear Madam:

RE: Assaying on Mining Claim TB 489922  
in the Area of Crescent Lake

---

The data for assaying as shown on the attached statement  
has been approved as of the above date.

Please inform the recorded holder of this mining claim  
and so indicate on your records.

Yours very truly,

E.F. Anderson  
Director  
Land Management Branch

Whitney Block, Room 6450  
Queen's Park  
Toronto, Ontario  
M7A 1W3  
Phone: 416/965-1380

A. Barr:sc

cc: Bird River Mines Limited  
Winnipeg, Manitoba  
Attn: Mr. J. Donner

cc: Resident Geologist  
Thunder Bay, Ontario

**Recorded Holder**  
 JOHN DONNER

**Township or Area**  
 CRESCENT LAKE AREA

Type of survey and number of Assessment days credit per claim	Mining Claims Assessed
<p><b>Geophysical</b></p> <p>Electromagnetic _____ days</p> <p>Magnetometer _____ days</p> <p>Radiometric _____ days</p> <p>Induced polarization _____ days</p> <p>77(19) See across _____ days</p> <p><del>86(18)</del></p> <p><b>Geological</b> _____ days</p> <p><b>Geochemical</b> _____ days</p> <p>Man days <input type="checkbox"/> Airborne <input type="checkbox"/></p> <p>Special provision <input type="checkbox"/> Ground <input checked="" type="checkbox"/></p> <p><input type="checkbox"/> Credits have been reduced because of partial coverage of claims.</p> <p><input type="checkbox"/> Credits have been reduced because of corrections to work dates and figures of applicant.</p>	<p>\$110.00 spent on assaying of samples taken from Mining Claim TB 489922.</p> <p>7 assessment work days are allowed which may be grouped in accordance with Section 76(6) of the Mining Act RSO 1980.</p> <p>For Mining Recorder's use.</p> <p>The work assignment for the above listed claim is 7 days.</p>

**Special credits under section 86 (15a) for the following mining claims**

**No credits have been allowed for the following mining claims**

not sufficiently covered by the survey
  Insufficient technical data filed

The Mining Recorder may reduce the above credits if necessary in order that the total number of approved assessment days recorded on each claim does not exceed the maximum allowed as follows: Geophysical — 80; Geological — 40; Geochemical — 40; Section 86(18)-60:

Mining Lands Comments

To: Geophysics

Comments		
<input type="checkbox"/> Approved	<input type="checkbox"/> Wish to see again with corrections	Date
		Signature

To: Geology - Expenditures

*Mr. Kustro*

Comments		
<input checked="" type="checkbox"/> Approved	<input type="checkbox"/> Wish to see again with corrections	Date
		Signature

*Oct 14/82*      *C/Kustro*

To: Geochemistry

Comments		
<input type="checkbox"/> Approved	<input type="checkbox"/> Wish to see again with corrections	Date
		Signature

*LD*

To: Mining Lands Section, Room 6462, Whitney Block.

(Tel: 5-1380)

1982 04 20

2.4698

Mining Recorder  
Ministry of Natural Resources  
P.O. Box 5000  
Thunder Bay, Ontario  
P7C 5G6

Dear Sir:

We have received data for Assaying submitted under Section 77(19) of the Mining Act R.S.O. 1980 on Mining Claim TB 489922 in the Area of Crescent Lake.

This material will be examined and assessed and a statement of assessment work credits will be issued.

Yours very truly,

E.F. Anderson  
Director  
Land Management Branch

Whitney Park, Room 6450  
Queen's Park  
Toronto, Ontario  
M7A 1W3  
Phone: 416/965-1316

J. Skura/amc

cc: Bird River Mines Limited  
Winnipeg, Manitoba  
Attn: Mr. J. Donner



Ontario

Ministry of  
Natural  
Resources

Notification of recording  
of assessment work credits

**RECEIVED**

APR - 2 1982

**MINING LANDS SECTION**

Lands Administration Branch  
Mining Lands Section  
Ministry of Natural Resources  
Room 1617, Whitney Block  
Queen's Park, Toronto  
M7A 1W3

Date of recording of work: March 26, 1982

Recorded holder: John Donner

Address: 98 Balmoral St., Winnipeg, Man. R3C 1X4

Township or Area: Crescent Lake Area (G27)

Type of survey and number of Assessment days credit per claim	Mining claims
Geophysical	TB489922
Electromagnetic _____ days	
Magnetometer _____ days	
Radiometric _____ days	
Induced polarization _____ days	
Section 86 (18) <u>7</u> days	
Geological _____ days	
Geochemical _____ days	
Man days <input type="checkbox"/> Airborne <input type="checkbox"/>	
Special provision <input type="checkbox"/> Ground <input checked="" type="checkbox"/>	

Notice to recorded holder:

- Survey reports and maps in duplicate be submitted to the Lands Administration Branch, Toronto within 60 days from the date of recording of this work.
- Reports and maps are being forwarded to the Lands Administration Branch with this letter.

*Audrey M. Hayes*  
A.M. Hayes

Acting  
c.c.

Mining recorder

John Donner  
98 Balmoral St.,  
Winnipeg, Manitoba.



# BONDAR-CLEGG & COMPANY LTD.

104 BELFAST ROAD, OTTAWA, ONTARIO, K1G 0Z5 PHONE: 237-3110 TELEX: 053-4455

Bird River Mines Limited  
98 Balmoral Street  
Winnipeg, Manitoba  
R3C 1X4

Attention: Mr. J. Donner

INVOICE: **F 02385**

DATE: **January 27, 1982**

REPORT NO: **A-12-58**

PROJECT:

---

5	Analyses of Beryllium	@ \$5.00	<u>\$25.00</u>
---	-----------------------	----------	----------------

dr *Has been paid*  
*J.D.*

*11-*

THIS IS A PROFESSIONAL SERVICE  
ACCOUNTS DUE WHEN RENDERED



REFERENCES

MOULE LAKE G-91

REFERENCES

TOPOGRAPHY  
LAKES, RIVERS, ETC. FROM FOREST RESOURCES  
INVENTORY SHEET NO. 504882

SURVEYS

BASELINE BY BEATTY AND BEATTY O.L.S  
1927-1928 FIELD NOTE BOOKS 2297 AND 2298  
CHAPPAIS LAKE DAM SITE PLAN N° 61-C-175  
FILE 57614 Vol. 3 10/5/41  
OGOKI DIVERSION (H.E.P.C.) L.O. 6192  
PLANS R 13-6, L 23-39

LEGEND

- HIGHWAY AND ROUTE No.
- OTHER ROADS
- TRAILS
- SURVEYED LINES:
  - TOWNSHIPS, BASE LINES, ETC.
  - LOTS, MINING CLAIMS, PARCELS, ETC.
- UNSURVEYED LINES:
  - LOT LINES
  - PARCEL BOUNDARY
  - MINING CLAIMS ETC.
- RAILWAY AND RIGHT OF WAY
- UTILITY LINES
- NON-PERENNIAL STREAM
- FLOODING OR FLOODING RIGHTS
- SUBDIVISION OR COMPOSITE PLAN RESERVATIONS
- ORIGINAL SHORELINE
- MARSH OR MUSKEG
- MINES
- TRAVERSE MONUMENT

DISPOSITION OF CROWN LANDS

TYPE OF DOCUMENT	SYMBOL
PATENT, SURFACE & MINING RIGHTS	●
" SURFACE RIGHTS ONLY	○
" MINING RIGHTS ONLY	◐
LEASE, SURFACE & MINING RIGHTS	◑
" SURFACE RIGHTS ONLY	◒
" MINING RIGHTS ONLY	◓
LICENCE OF OCCUPATION	◔
ORDER-IN-COUNCIL	OC
RESERVATION	○
CANCELLED	○
SAND & GRAVEL	⊙

NOTE: MINING RIGHTS IN PARCELS PATENTED PRIOR TO MAY 6, 1913, VESTED IN ORIGINAL PATENTEE BY THE PUBLIC LANDS ACT, R.S.O. 1970, CHAP. 380, SEC. 63, SUBSEC. 1.

SCALE: 1 INCH = 40 CHAINS

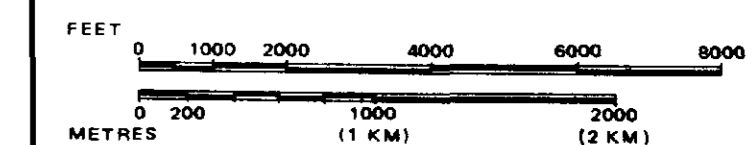

DATE OF ISSUE

NOV 24 1982

Ministry of Natural Resources  
TORONTO

AREA  
**CRESCENT LAKE**

M.N.R. ADMINISTRATIVE DISTRICT  
**NIPIGON**  
MINING DIVISION  
**THUNDER BAY**  
LAND TITLES / REGISTRY DIVISION  
**THUNDER BAY**

Ministry of Natural Resources  
Land Management Branch

Date FEB. 1981

Number

**G-27**

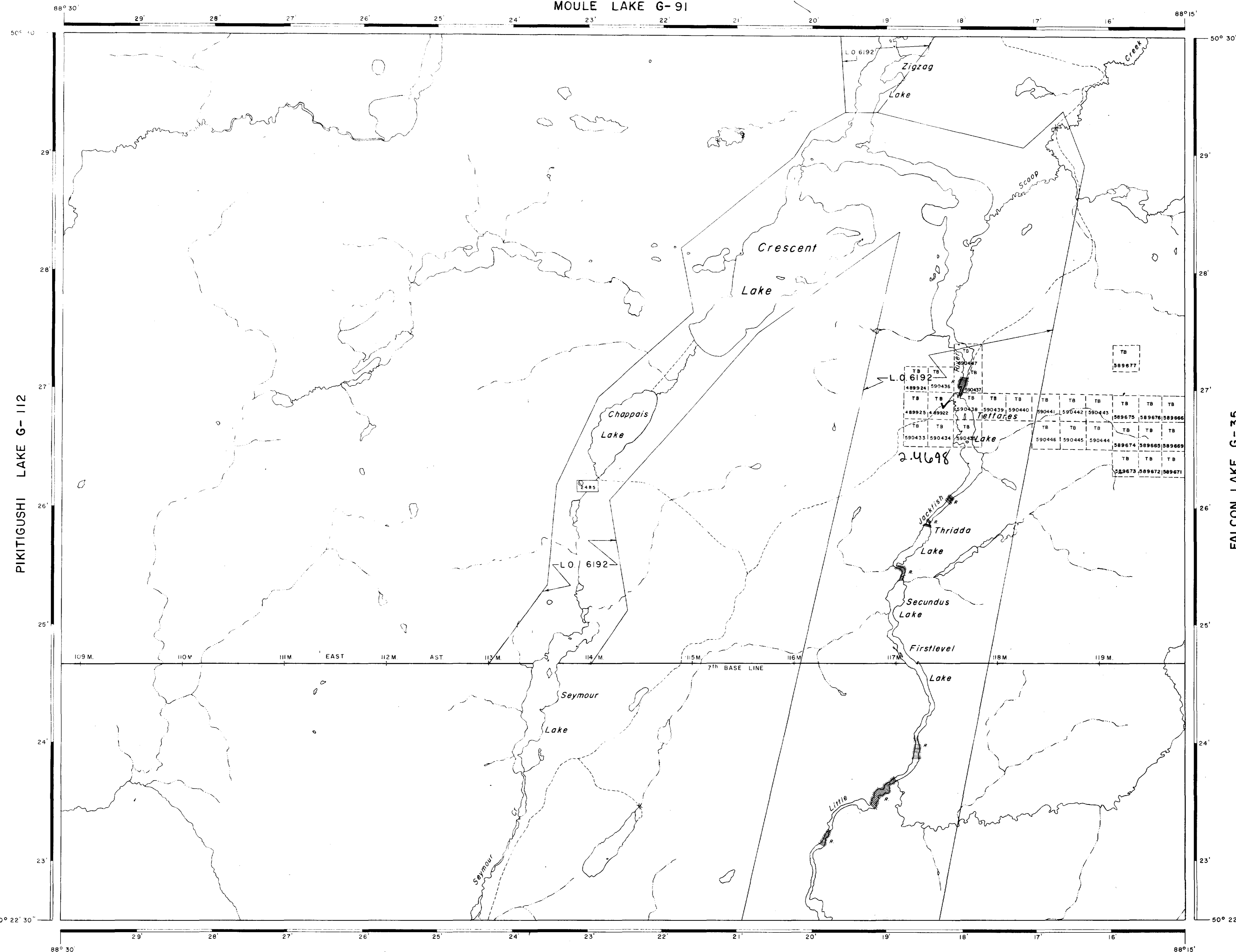

FERLAND STATION G-36



5210RNP002 2,4698 CRESCENT LAKE